

- REPRESENTS OCCUPIED SPACE
- REPRESENTS AVAILABLE SPACE
- REPRESENTS COMING AVAILABLE

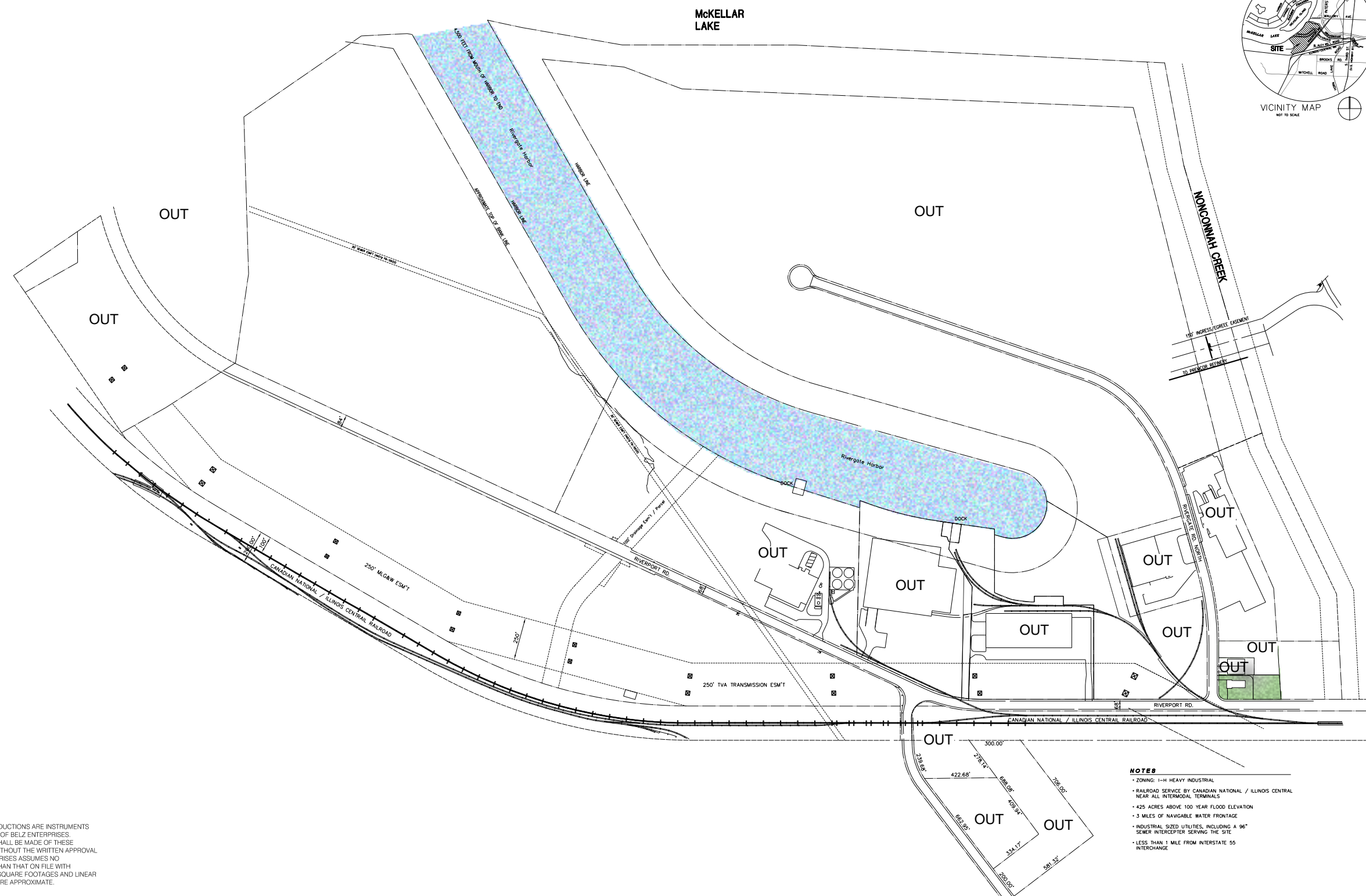

- NOTES**
- ZONING: I-H HEAVY INDUSTRIAL
 - RAILROAD SERVICE BY CANADIAN NATIONAL / ILLINOIS CENTRAL NEAR ALL INTERMODAL TERMINALS
 - 425 ACRES ABOVE 100 YEAR FLOOD ELEVATION
 - 3 MILES OF NAVIGABLE WATER FRONTAGE
 - INDUSTRIAL SIZED UTILITIES, INCLUDING A 96" SEWER INTERCEPTOR SERVING THE SITE
 - LESS THAN 1 MILE FROM INTERSTATE 55 INTERCHANGE

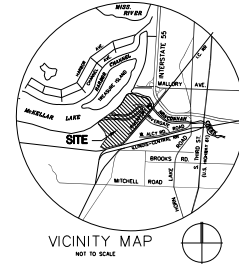

TENANT OCCUPANCY PLAN
RIVERGATE INDUSTRIAL PORT
RIVERPORT ROAD • RIVERGATE ROAD
MEMPHIS, TN

REVISED
9:39 am, Dec 01, 2011

NOTE:
THESE DRAWINGS AND THEIR REPRODUCTIONS ARE INSTRUMENTS OF SERVICE AND ARE THE PROPERTY OF BELZ ENTERPRISES. NO REPRODUCTION OR REVISIONS SHALL BE MADE OF THESE DOCUMENTS OR REPRODUCTIONS WITHOUT THE WRITTEN APPROVAL OF BELZ ENTERPRISES. BELZ ENTERPRISES ASSUMES NO RESPONSIBILITY FOR WORK OTHER THAN THAT ON FILE WITH THE LOCAL BUILDING DEPARTMENT. SQUARE FOOTAGES AND LINEAR DIMENSIONS SHOWN ON THIS PLAN ARE APPROXIMATE.